

JET P

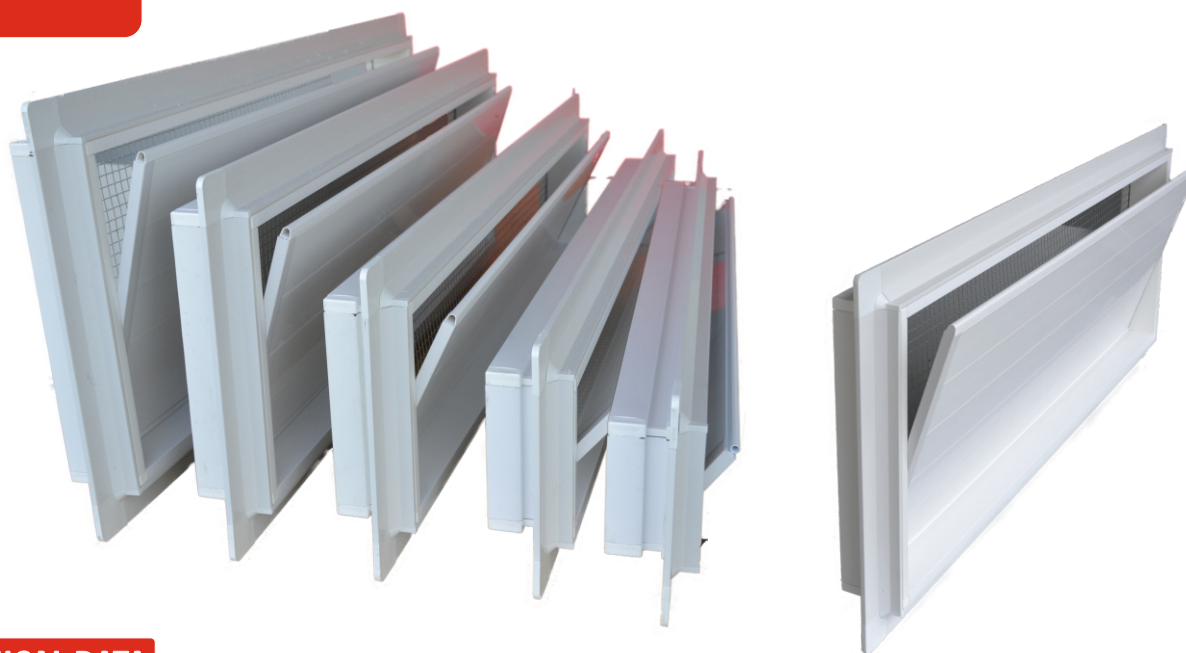

TECHNICAL DATA

- Entirely built in condensation-proof impact-resistant PVC.
- ABS corner fittings.
- Alveolar PVC "curved" flap for optimum orientation of the flow of the incoming air flow.
- Air seal brush horizontally and on both sides of the flap.
- Smooth surface flap to improve the flow of incoming air and minimize dust deposits.
- Arc-welded and galvanised protective mesh. (stainless steel on request)
- One important feature of our air inlets is the option of personalized sizing relative to the housing wall, depending on the thickness of the wall and installation needs.
- See our wide range of accessories and optionals for complete installation (pag 6).

Air flow in m³/h at negative pressure 20 Pa of the various models:

MODEL	JET P 14/60	JET P 14/80	JET P 14/100	JET P 14/120	JET P 21/60	JET P 21/80	JET P 21/100	JET P 21/120
m ³ /h	1400	1700	1900	2100	2600	3000	3500	3900

Force required in Kg. to close the JET flap

FORCE Kg.	1,0	1,2	1,3	1,5	1,2	1,3	1,5	1,7
--------------	-----	-----	-----	-----	-----	-----	-----	-----

SIZES AND MODELS

MODEL WITH **STANDARD WALL RECESS SIZES 80mm** and only contact type **A**

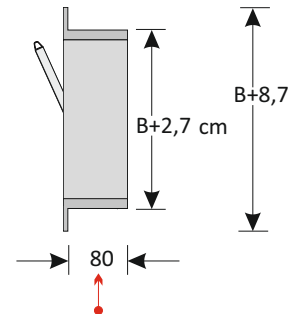
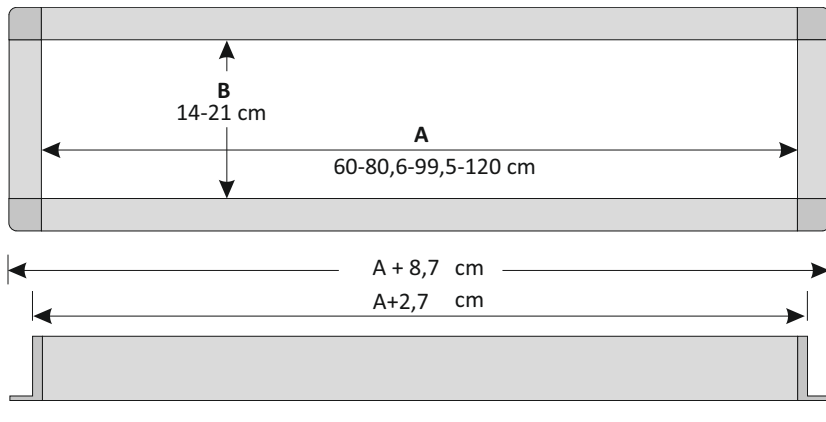

Recess wall sizes 80 mm
Over 80 mm see our optionals: **EXTENSION JET**

	JET P 14		JET P 21	
HEIGHT B	14	21		
LENGTH A	60	60		
	80,6	80,6		
	99,5	99,5		
	120	120		

NB: OTHER SIZES ON REQUEST

IN ORDER SPECIFY:

JET sizes B / sizes A / contact A / flap / wall recess 80

EXAMPLE

JET P 14 / 100 / A / O / 80

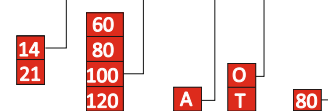

MODELS WITH **WALL RECESS SIZES ON REQUEST** and contact type **A** or **B**

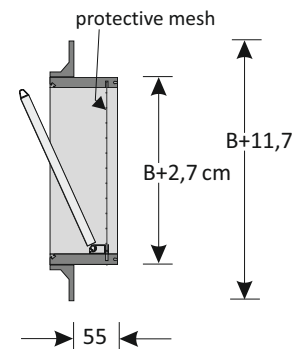
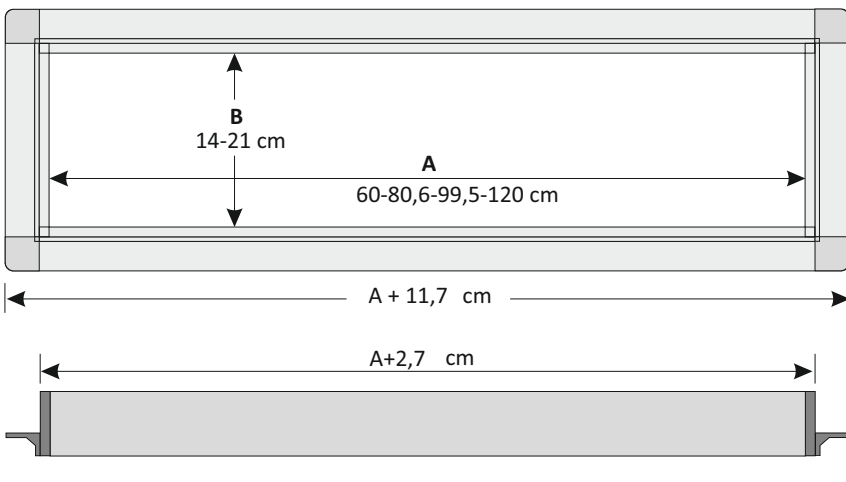

Recess wall sizes 55mm other measurements on request (from 0 to 60 mm)
Over 60 mm see our optionals: **EXTENSION JET**

	JET P 14		JET P 21	
HEIGHT B	14	21		
LENGTH A	60	60		
	80,6	80,6		
	99,5	99,5		
	120	120		

NB: OTHER SIZES ON REQUEST

IN ORDER SPECIFY:

JET sizes B / sizes A / contact A / flap / wall recess

EXAMPLE

JET P 14 / 80 / A / O / 55

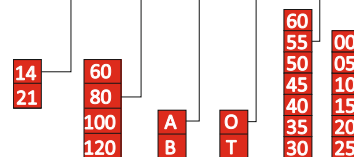

For **configuration options** , **optionals** and **accessories** see model «JET» from pag. 3 to pag. 8